



Sales Price: \$180,000

16399 96th Street

Lexington, Oklahoma 73051

PROPERTY HIGHLIGHTS

- **8.89 Acres MOL**
- Zoning: Unincorporated Cleveland County
- Excellent for Residential or Industrial Development
- Rural Water & Electricity Available
- Application Submitted for 3 Water Wells
- 440' on Frontage on Paved Road
- Dimensions: 440' x 880'
- Near I-35
- 40 Miles South of Downtown Oklahoma City
- 18 Miles South of Downtown Norman, OK

Bob Sullivan, CCIM

+1 405 641 9798

bob@naisullivangroup.com

Clark Everett

+1 405 985 8424

clark@naisullivangroup.com

+1 405 840 0600 OFFICE

4045 N.W. 64th Street, Suite 340
Oklahoma City, OK 73116

www.naisullivangroup.com

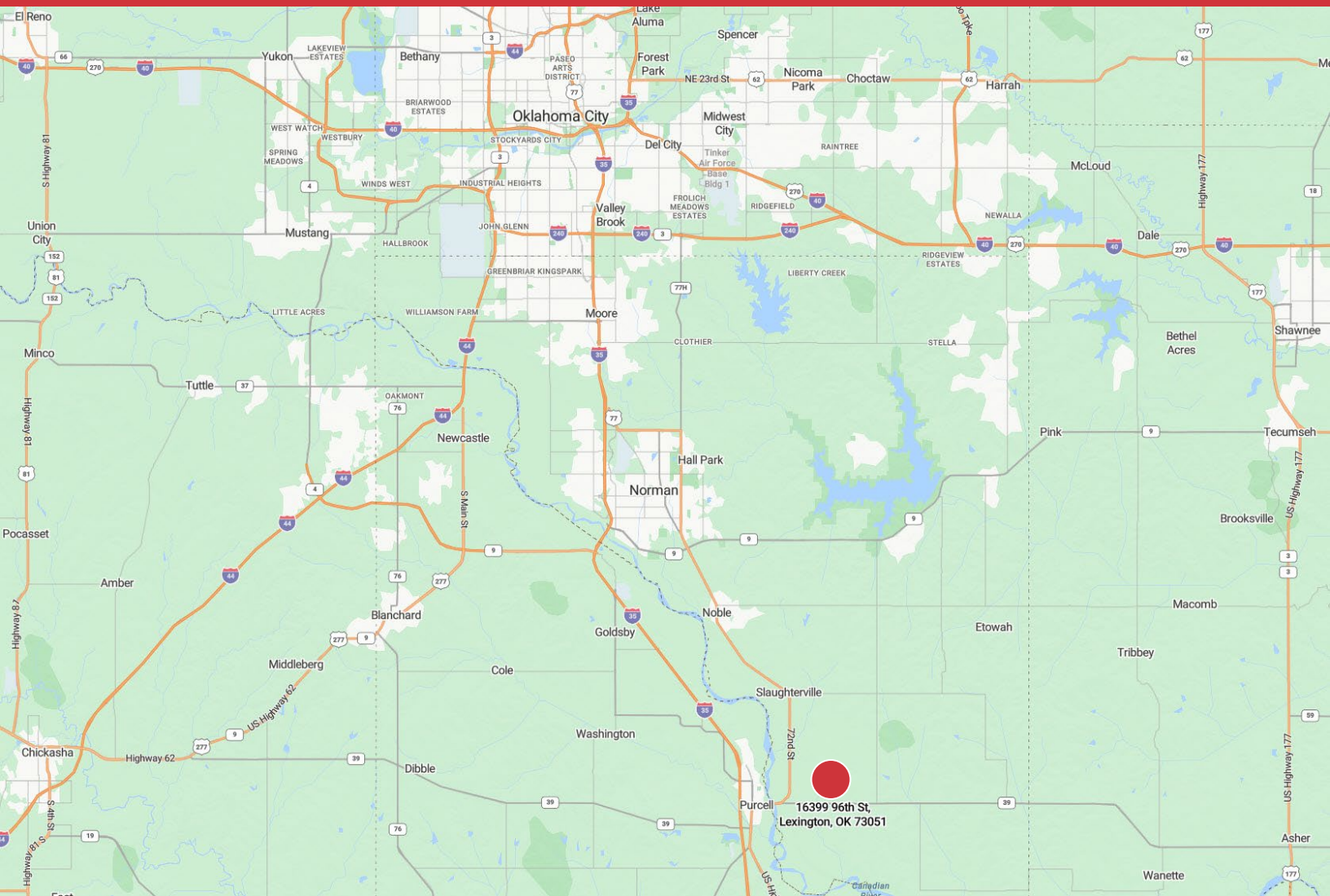

Population	1 Mile: 206	3 Miles: 2,900	5 Miles: 11,338
Average Household Income	1 Mile: \$88,604	3 Miles: \$66,569	5 Miles: \$75,902
Total Households	1 Mile: 78	3 Miles: 1,052	5 Miles: 3,794

Bob Sullivan, CCIM
+1 405 641 9798
bob@naisullivangroup.com

Clark Everett
+1 405 985 8424
clark@naisullivangroup.com

+1 405 840 0600 OFFICE

4045 N.W. 64th Street, Suite 340
Oklahoma City, OK 73116

www.naisullivangroup.com